

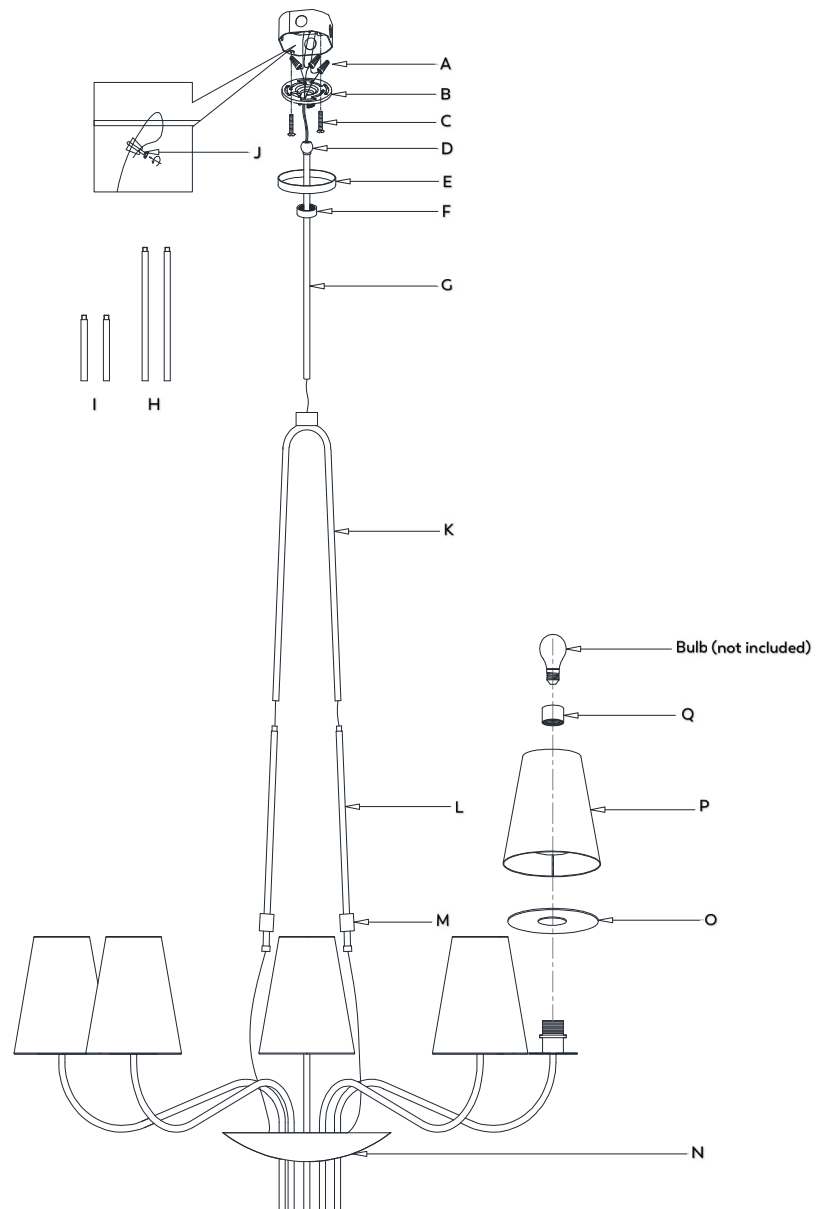

## PARTS INCLUDED

- (A) Plastic Wire Connectors (3)
- (B) Mounting Plate (1)
- (C) Outlet Screws (2)
- (D) Swivel Ball (1)
- (E) Canopy (1)
- (F) Canopy Secure Ring (1)
- (G) 18" Extension Tubes (2)
- (H) 12" Extension Tubes (2)
- (I) 6" Extension Tubes (2)
- (J) Safety Cable (1)
- (K) U-shape Metal Frame (1)
- (L) Metal Tubes (2)
- (M) Fixed Collars (2)
- (N) Fixture Body (1)
- (O) Acrylic Diffusers (8)
- (P) Lamp Shades (8)
- (Q) Socket Rings (8)



#### IMPORTANT: PLEASE READ

PLEASE FOLLOW THE ASSEMBLY INSTRUCTIONS CLOSELY. IMPROPER ASSEMBLY OR INSTALLATION CAN RESULT IN PERSONAL OR PROPERTY DAMAGE. MOUNTING HARDWARE HAS BEEN PROVIDED FOR MOUNTING DIRECTLY TO A JUNCTION BOX. UNIQUE OR ALTERNATIVE INSTALLATION METHODS MAY REQUIRE DIFFERENT MOUNTING HARDWARE, WHICH HAS NOT BEEN INCLUDED. ALWAYS CONSULT WITH A LICENSED ELECTRICIAN BEFORE INSTALLATION.

INSTALLATION BY A LICENSED ELECTRICIAN IS STRONGLY RECOMMENDED.

#### IMPORTANT SAFETY FEATURES

##### BULBS

This fixture has been rated for eight (8) 8.5W LED Type A bulbs (not included). To avoid the risk of fire, do not exceed the recommended wattage.

##### VAULTED-CEILING COMPATIBILITY

This fixture is vaulted-ceiling compatible up to a maximum ceiling slope of 90 degrees.

##### DIMMER-SWITCH COMPATIBILITY

This fixture is dimmer-switch compatible.

##### CEILING REINFORCEMENT

Fixtures weighing 126.5 lbs, or more will require additional Reinforcement above the ceiling where they are to be installed.

#### WARNINGS

All wires are connected. When unpacking, be careful not to pull wires, as damage may result. Do not connect electricity until the fixture is fully assembled. To reduce the risk of fire, electrical shock, or personal injury, always turn off fixture and allow it to cool prior to replacing the light bulb. Do not touch or look directly at the bulb when fixture is illuminated. Keep flammable materials away from lit bulb.



**WARNING:** This product can expose you to lead, which is known to the State of California to cause cancer and birth defects or other reproductive harm.

For more information, go to [www.P65Warnings.ca.gov](http://www.P65Warnings.ca.gov).

#### WARNING: STRANGULATION HAZARD

Keep cord at least 3 feet away from cribs, bassinets, and toddler beds. Keep out of reach of children under 3 years of age.

THIS PRODUCT IS NOT A TOY AND HAS NO PLAY VALUE.

#### SAFETY CABLE INSTALLATION

The ceiling must have at least the capacity of holding 5 times the weight of the fixture. For this fixture, a ceiling capacity of at least 126.5 lbs (57.5kgs) is required.

Installation (see Figure 1)

1. Disconnect power at main electrical panel before installation.
2. If installing on a cement ceiling, please use expansion bolt to install. If installing on a wood ceiling, please use plastic anchor and tapping screw to install. Drill two holes into the ceiling (load-bearing structure) and hammer an expansion bolt into the holes, or use screwdriver to insert plastic anchor.
3. Attach the mounting plate (B) to the junction box (T) using two outlet screws (C).
4. Assemble the fixture as shown in reference diagram.
5. Raise the fixture to ceiling and place the safety cable (J) through the mounting plate (B) and secure with lock and screws.
6. Attach the fixture's wires to the power supply wires from the ceiling. Connect black to black (or smooth); white to white (or ribbed); ground to ground (green or copper). Twist the ends of the wire pairs together, then twist on a plastic wire connector (A). Make sure all twists are in the same direction.
7. Place the canopy (E) on the fixture, cover the mounting plate (B) and secure with canopy secure ring (F).

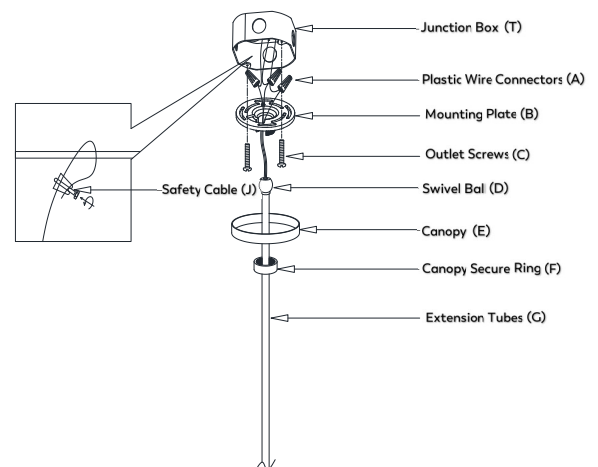

Figure 1

## ASSEMBLY AND INSTALLATION

### SHUT OFF THE MAIN ELECTRICAL SUPPLY FROM THE FUSE BOX OR CIRCUIT BREAKER PANEL.

1. Remove all parts from the carton and remove all plastic coverings. Then put them neatly.
2. Screw the metal tubes (L) into the U-shape metal frame (K). Adjust the wires. Screw the fixed collars (M) into the fixture body (N). Use the wires to through some or all (G) (H) (I) extension tubes and swivel ball (D) according to the height needed.
3. Separate the canopy secure ring (F), canopy (E) and mounting plate (B).
4. Remove the swivel ball (D) from 6" extension tubes(I). Put the canopy (E) and canopy secure ring (F) into 6" extension tubes(I).
5. Fasten the mounting plate (B) onto the junction box using outlet screws (C). Attach the swivel ball (D) onto the 6" extension tubes(I). Insert the swivel ball (D) to the mounting plate (B).
6. Thread the safety cable (J) through the mounting plate (B) and secure with lock and screws.
7. Connect the ground wire (Green) to the building ground wire (usually bare copper). Connect other wires according to the color (white to white, black to black). Fasten with plastic wire connectors (A). Refer to the wiring diagram on the following page for accurate wire connections. Cut the excess wires after professional installation.
8. Attach canopy (E) to mounting plate (B) and fully tighten with canopy secure ring (F).
9. Remove the socket rings (Q). Put the acrylic diffusers (O) on the socket plate.
10. Insert the lamp shades (P) on the socket and fully tighten with socket rings (Q).
11. Fix the bulbs in the socket.
12. Restore the power to the junction box and test fixture.
13. Assembly is complete.

HEIGHT ADJUSTMENT INSTRUCTIONS

- 1. Feed the wires through 18" Extension Tube (G), then thread 18" Extension Tube (G) to the joint of Fixture Body (S).
- 2. Feed the wires through 12" Extension Tube (H), then thread 12" Extension Tube (H) to 18" Extension Tube (G).
- 3. Feed the wires through 6" Extension Tube (I), then thread 6" Extension Tube (I) to 12" Extension Tube (H).

ATTENTION:  
ADJUSTING THE HANG HEIGHT

Any adjustments or alterations to the fixture, cord, or overall hang height that differ from those detailed on our website will void the Laboratory Listing and Approvals (UL, ETL, CSA, etc.). If the listing is voided, this means the product may no longer be safe for use as modified.

We do not recommend modifying the product.

CARE INSTRUCTIONS

Do not use polishes or cleaners on the fixture.  
Wipe clean with a soft, dry cloth.

